

Technical Data Sheet

CODE 17170

LINEO 100 QUIET ES

Sound-proof energy saving mixed flow
extractor fans



Certifications



Technical and performance data

Corrente max assorbita a 2V (A)	0,08	Max pressure at 6V (Pa)	56,9
Frequency (Hz)	50-60	Max pressure at 10V (mmH2O)	24,8
Insulation class	II°	Max pressure at 4V (mmH2O)	3,5
IP	45	Max pressure at 6V (mmH2O)	58
Max absorbed current at 10V (A)	0,26	Max pressure at 8V (mmH2O)	11,4
Max absorbed current at 4V (A)	0,09	Max pressure at 8V (Pa)	111,8
Max absorbed current at 6V (A)	0,12	Portata max a 2V (l/s)	13,6
Max absorbed current at 8V (A)	0,18	Portata max a 2V (m3/h)	49
Max absorbed power at 10V (W)	23	Potenza sonora Lw [dB (A)] IN ASPIRAZIONE - a 2V	46,6
Max absorbed power at 4V (W)	6,2	Potenza sonora Lw [dB (A)] IN MANDATA - a 2V	44
Max absorbed power at 6V (W)	8,3	Pressione max a 2V (mmH2O)	0,5
Max absorbed power at 8V (W)	14,7	Pressione max a 2V (Pa)	4,9
Max ambient temperature for continuous operation (°C)	60	Pressione sonora Lp [dB (A)] 3m IN ASPIRAZIONE - a 2V	29,1
Nominal diameter (mm)	100	Pressione sonora Lp [dB (A)] 3m IN MANDATA - a 2V	26,5
Potenza max assorbita a 2V (W)	3,6	Pressione sonora Lp [dB (A)] 3m IRRADIATO - a 2V	8,8
Voltage (V)	220-240	RPM 2V	470
Weight (Kg)	3,8	RPM at 10V	2510
Breakout sound power at 10V Lw [dB (A)]	51,4	RPM at 4V	1140
Breakout sound power at 2V LWA [dB (A)]	29,3	RPM at 6V	1450
Breakout sound power at 4V Lw [dB (A)]	30,4	RPM at 8V	2050
Breakout sound power at 6V Lw [dB (A)]	36,4	Sound power at extract side at 10V speed LWA [dB (A)]	55,6
Breakout sound power at 8V Lw [dB (A)]	45,3	Sound power at extract side at 4V speed LWA [dB (A)]	37,7
Breakout sound pressure at 3m at 10V Lp [dB (A)]	30,9	Sound power at extract side at 6V speed LWA [dB (A)]	42,9
Breakout sound pressure at 3m at 4V Lp [dB (A)]	9,9	Sound power at extract side at 8V speed LWA [dB (A)]	53,4
Breakout sound pressure at 3m at 6V Lp [dB (A)]	15,9	Sound power at supply side at 10V speed LWA [dB (A)]	58,2
Breakout sound pressure at 3m at 8V Lp [dB (A)]	24,8	Sound power at supply side at 4V speed LWA [dB (A)]	38,1
Max airflow at 10V (l/s)	83,3	Sound power at supply side at 6V speed LWA [dB (A)]	43,6
Max airflow at 10V (m³/h)	300	Sound power at supply side at 8V speed LWA [dB (A)]	54,2
Max airflow at 4V (l/s)	37,5	Sound pressure at extract side at 3m at 10V Lp [dB (A)]	38,1
Max airflow at 4V (m³/h)	135	Sound pressure at extract side at 3m at 4V Lp [dB (A)]	20,2
Max airflow at 6V (l/s)	48,6	Sound pressure at extract side at 3m at 6V Lp [dB (A)]	25,4
Max airflow at 6V (m³/h)	175	Sound pressure at extract side at 3m at 8V Lp [dB (A)]	35,9
Max airflow at 8V (l/s)	69,4	Sound pressure at suply side at 3m at 10V Lp [dB (A)]	40,7
Max airflow at 8V (m³/h)	250	Sound pressure at suply side at 3m at 4V Lp [dB (A)]	20,6
Max pressure at 10V (Pa)	243,2	Sound pressure at suply side at 3m at 6V	26,1
Max pressure at 4V (Pa)	34,3		

Lp [dB (A)]	
Sound pressure at suply side at 3m at 8V	36,7
Lp [dB (A)]	

Dimensions

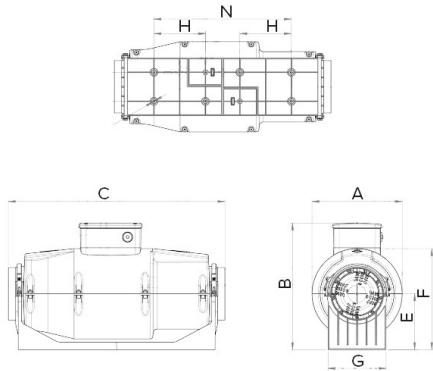

Size A (mm)	210
Size B (mm)	294,6
Size C (mm)	639
Size D (mm)	Ø 97
Size E (mm)	130
Size F (mm)	235
Size G (mm)	135
Size H (mm)	120
Size L (mm)	67,5
Size M (mm)	Ø 5,5
Size N (mm)	320

PER INFORMAZIONI / FOR INFORMATION

ITALY

Pre Sales:
prevendita@vortice-italy.com
 After Sales:
postvendita@vortice-italy.com

UNITED KINGDOM & REP. OF

IRELAND
 Sales Dept:
sales@vortice.ltd.uk
 Technical Dept:
technical@vortice.ltd.uk

OTHER COUNTRIES

Sales Dept:
export@vortice-italy.com
 After Sales:
after-sales@vortice-italy.com

Technical Data Sheet

CODE 17170



LINEO 100 QUIET ES

Sound-proof energy saving mixed flow extractor fans

Description

- Enclosures made of fire resistant plastic resin, E2 class, according with ISO EN 11925-2: 2010, in areas close to motor and electrical components.
- Casing integrating a sound-absorbing coating, optimized to minimize sound emissions radiated into the environment and transmitted through exhaust and supply ducts.
- Nominal diameter 100 mm.
- EC (brushless) motor, thermally protected, with shaft mounted on ball bearing supports, coupled with a centrifugal impeller.
- High water resistance: IPX5 (if installed in a duct).
- Equipped with a thermal fuse overheating safety device.
- Speed adjustable through potentiometer (0-10V signal) or two-speed switch (to be set at the installation in a preset range).

Curves

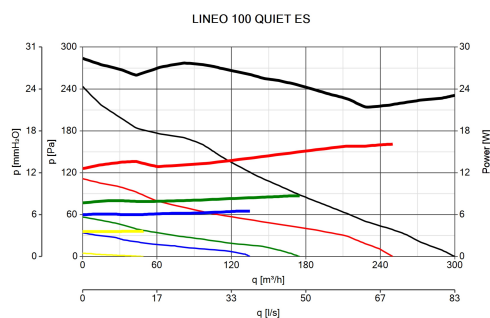

Accessories



C TEMP
Code 12992



C SMOKE
Code 12993



C HCS
Code 12994



C PIR
Code 12998



C TIMER
Code 12999



POT-IT
Code 12826



POT
Code 12828

PER INFORMAZIONI / FOR INFORMATION

ITALY
Pre Sales:
prevendita@vortice-italy.com

UNITED KINGDOM & REP. OF
IRELAND
Sales Dept:
sales@vortice.ltd.uk

OTHER COUNTRIES
Sales Dept:
export@vortice-italy.com

After Sales:
postvendita@vortice-italy.com

Technical Dept:
technical@vortice.ltd.uk

After Sales:
after-sales@vortice-italy.com